

YSRT2-26.5-S

Coaxial RF Termination, DC-26.5 GHz, 2 W, SMA Connector, 50 Ohm

Key Features

- 2 W avg. power @ 25°C
- DC to 26.5 GHz frequency range
- VSWR ≤1.25
- SMA female or male connector options
- Passivated stainless steel body

Applications

- Test & measurement systems
- Microwave & RF laboratory setups
- High-frequency communication systems
- Radar and aerospace electronics
- Component characterization and calibration

Electrical Specifications		
1	Nominal Impedance	50 Ω
2	Average Power ¹	2 W @ 25°C
3	Peak Power	20 W (pulse width: 5μs, duty cycle: 1%)
4	Frequency Range	DC-26.5 GHz
5	VSWR	≤1.25
Environmental Specifications		
1	Operating Temperature	-55°C to +125°C
Mechanical Specifications		
1	Connectors	SMA Female / Male
2	Body Material	Passivated Stainless Steel

Note 1: Refer to the power derating curve for details.

Outline Drawing (Units: mm/[inch], Tolerance: ±0.2 mm)

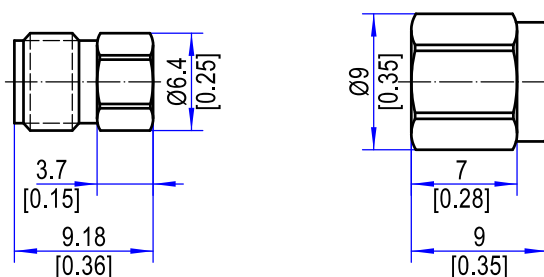

Outline A

Outline B

Ordering Information:

Model	Connector Type	Outline Drawing
YSRT2-26.5-S	SMA Female (default)	Outline A
YSRT2-26.5-SM	SMA Male	Outline B