

YSRSA25-26-70-10A5

Rotary Step Attenuator, 25 W, DC-26.5 GHz, 0-90 dB

Key Features

- Broadband Operation (DC-26.5 GHz)
- High Precision Attenuation Control
- High Power Handling up to 25 W
- Flexible Connector Options
- Rugged & Reliable Mechanical Design

Applications

- RF & Microwave Test Systems
- Signal Simulation & Calibration
- Receiver Protection
- EMC / EMI Testing
- System Integration & Lab Use

Electrical Specifications						
Impedance	50 Ω					
Average Power	2 W/10 W/25 W					
Peak Power	200 W (pulse width: 5 μ s , duty cycle: 2%)					
Freq. (GHz)	Attenuation		VSWR (Max.)	Insertion Loss (dB.Max.)	Accuracy(dB)	Power (CW)
	Range	Step Size				
DC-8	0-9 dB	1 dB	1.40	0.8	± 0.6	2 W 10 W
DC-12.4			1.50	1.0	± 0.8	
DC-18			1.60	1.2	± 1.0	
DC-26.5			1.75	1.8	± 1.0	
DC-8	0-90 dB	10 dB	1.40	1.0	± 1.5 (10-60 dB)	2 W 10 W
DC-12.4			1.50	1.2	± 2.5 or 3.5%	
DC-18			1.60	1.5	(70-90 dB)	
DC-18	0-70 dB	10 dB	1.65	1.0	± 1.5 or 4%	25 W
DC-26.5	0-60 dB	10 dB	1.75	1.8		10 W
			1.80			25 W
Environmental Specifications						
Operating Temperature	0°C to +54°C					
Mechanical Specifications						
Connectors	SMA Female(DC-18GHz) 3.5mm Female(DC-26.5GHz)					
Body Material	Connector: Nickel Plated Brass Housing: Aluminum					
Dimension	Outline A: $\Phi 44 \times 97$ mm / [1.73 \times 3.82 in] Outline B: $\Phi 44 \times 108.5$ mm / [1.73 \times 4.27 in] Outline C: $\Phi 44 \times 112.6$ mm / [1.73 \times 4.43 in]					
Weight	Outline A: 220 g / Outline B: 280 g / Outline C: 300 g					

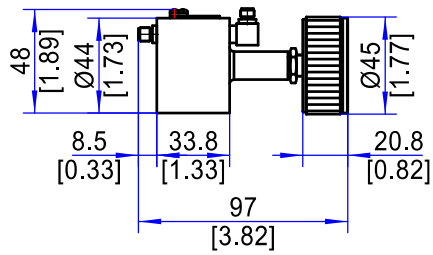
Outline Drawing (Units: mm/[inch], Tolerance: ± 0.5 mm)

Outline A(0~90dB/2W)

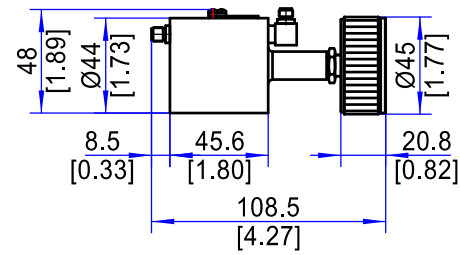

Outline B(0~90dB/2W,10W)

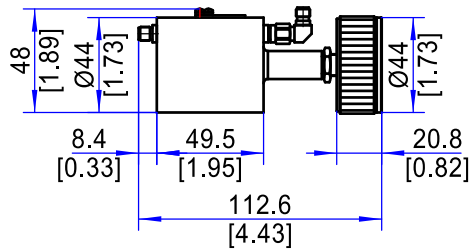

Outline C(0~90dB/25W)

Ordering Information:

 Model: **YRSAXX-YY-ZZ-CC**

XX = Power Handling

YY = Frequency Range in GHz

ZZ = Attenuation Range in dB (e.g. 70-10 = 0-70 dB range with 10 dB step size)

CC = Connector Type (S=SMA Female, 3=3.5 mm Female)

 Example: 18 GHz, 10 W, 0-70 dB in 10 dB Steps, SMA Female → **YRSA10-18-70-10A5-S**