

YSFA30-18-XX-N

Fixed Attenuator, DC to 18 GHz, 30 W, N-Type Connector

Key Features

- Ultra-wideband operation
- Stable attenuation over frequency
- Excellent impedance matching
- Compact and rugged design
- High reliability under extreme conditions

Applications

- RF and microwave test systems
- Millimeter-wave communication
- Signal conditioning in RF chains
- Instrumentation protection
- Aerospace and defense systems

Electrical Specifications					
1	Nominal Impedance	50 Ω			
2	Average Power ¹	30 W @ 25°C			
3	Frequency Range	DC to 4 GHz	DC to 8 GHz	DC to 12.4 GHz	DC to 18 GHz
4	VSWR	≤1.20	≤1.25	≤1.35	≤1.45
Environmental Specifications					
1	Operating Temperature	-55°C to +125°C			
Mechanical Specifications					
1	Connectors	N-Type Male to Female Other configurations available upon request			
2	Body Material	Connector: Brass Heat Sink: Black Anodized Aluminum			
3	Dimensions	Φ38×105 mm / [Φ1.5×4.13 in]			
Attenuation & Accuracy					
Attenuation (dB)	Accuracy(dB)				
	DC to 4 GHz	DC to 8 GHz	DC to 12.4 GHz	DC to 18 GHz	
1 to 10	±0.4	±0.5	±0.6	±0.6	
20	±0.5	±0.6	±0.7	±0.9	
30	±0.7	±0.8	±0.8	±1.0	
40	±0.7	±0.8	±1.0	±1.2	
50 to 60	±0.7	±0.8	±1.0	±1.3	

Note 1: Refer to the power derating curve for details.

Outline Drawing (Units: mm/[inch], Tolerance: ± 0.5 mm)

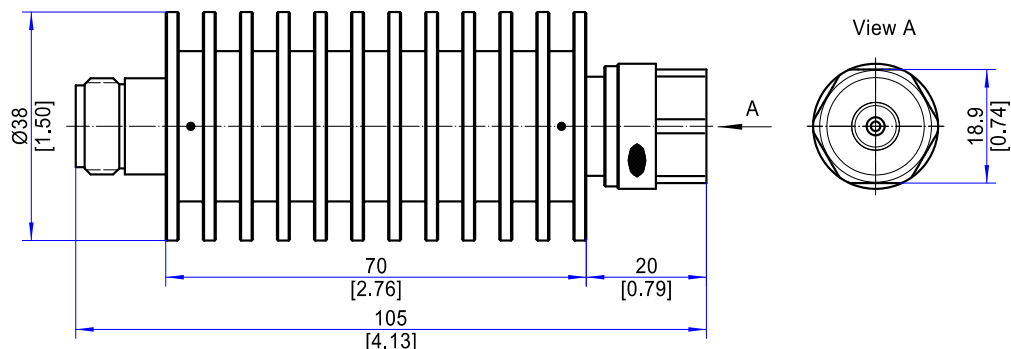

Ordering Information:Model: **YSFA30-XX-YY-N**

XX = Frequency Range (4 GHz, 8 GHz, 12.4 GHz, 18 GHz)

YY = Attenuation Value in dB

Example: 8 GHz, 20 dB→**YSFA30-8-20-N**