

YSFA150-18-XX-N

Fixed Attenuator, DC-18 GHz, 150 W, N-Type Connector

Key Features

- DC to 18 GHz Broadband Coverage
- 150 W Average / 1 kW Peak Power
- Low VSWR $\leq 1.40:1$
- Rugged Thermal Design
- Wide Temperature Range

Applications

- RF And Microwave Test Systems
- Millimeter-Wave Communication
- Signal Conditioning In RF Chains
- Instrumentation Protection
- Aerospace And Defense Systems

Electrical Specifications					
1	Nominal Impedance	50 Ω			
2	Average Power ¹	150 W @ 25°C			
3	Peak Power	1 KW (pulse width: 5 μ s, duty cycle: 7.5%)			
4	Frequency Range	DC-4 GHz	DC-8 GHz	DC-12.4 GHz	DC-18 GHz
5	VSWR	≤ 1.20	≤ 1.25	≤ 1.35	≤ 1.45
Environmental Specifications					
1	Operating Temperature	-55°C to +125°C			
Mechanical Specifications					
1	Connectors	N-Type Male to Female Other configurations available upon request			
2	Body Material	Connector: Brass Heat Sink: Black Anodized Aluminum			
3	Dimension	140×64×64 mm / [5.51×2.52×2.52 in]			
Attenuation, Accuracy & Dimension					
Attenuation (dB)	Accuracy(dB)				
	DC-4 GHz	DC-8 GHz	DC-12.4 GHz	DC-18 GHz	
0 to 6	± 0.7	± 0.8	± 0.9	± 2.0	

Note 1: Refer to the power derating curve for details.

Outline Drawing (Units: mm/[inch], Tolerance: ± 0.5 mm)

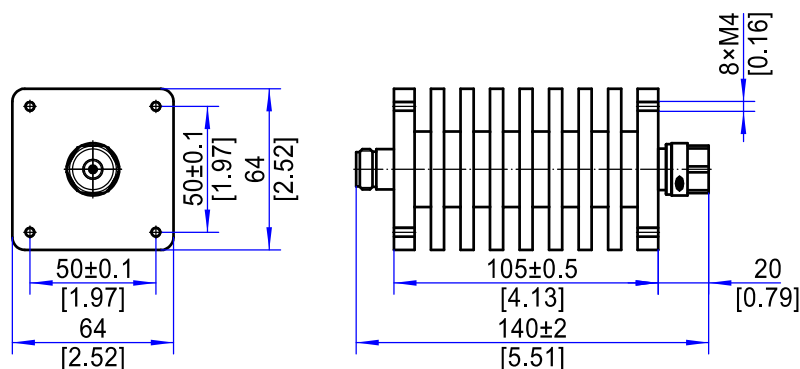

Ordering Information:Model: **YSFA150-XX-YY-N**

XX = Frequency Range (4 GHz, 8 GHz, 12.4 GHz, 18 GHz)

YY = Attenuation Value in dB

Example: 8 GHz, 20 dB→**YSFA150-8-20-N**