

# YSFA100-18-XX-S

Fixed Attenuator, DC-18 GHz, 100 W, SMA Connector

## Key Features

- DC to 18 GHz Ultra-Wideband
- 100 W High Power Handling
- Multiple Outline Options
- Low VSWR & High Accuracy
- Rugged & Reliable

## Applications

- RF And Microwave Test Systems
- Millimeter-Wave Communication
- Signal Conditioning In RF Chains
- Instrumentation Protection
- Aerospace And Defense Systems

Electrical Specifications					
1	Nominal Impedance	50 Ω			
2	Average Power <sup>1</sup>	100 W @ 25°C			
3	Frequency Range	DC-4 GHz	DC-8 GHz	DC-12.4 GHz	DC-18 GHz
4	VSWR	≤1.20	≤1.25	≤1.35	≤1.45
Environmental Specifications					
1	Operating Temperature	-55°C to +125°C			
Mechanical Specifications					
1	Connectors	SMA Male to Female Other configurations available upon request			
2	Body Material	Connector: Brass Heat Sink: Black Anodized Aluminum			
3	Dimension	Φ64×121 mm/[Φ2.52×6.34 in]			
Attenuation & Accuracy					
Attenuation (dB)	Accuracy(dB)				
	DC-4 GHz	DC-8 GHz	DC-12.4 GHz	DC-18 GHz	
6 to 10	±0.7	±0.8	±1.2	±1.5	
20	±0.7	±0.8	±0.9	±1.5	
30	±0.8	±0.9	±1.0	±1.3	
40	±0.8	±0.9	±1.0	±1.3	
50 to 70	±0.9~1.0	±1.0	±1.1	±1.4	

Note 1: Power derates linearly to 0.5 W at +125°C. Refer to the power derating curve for details.

## Outline Drawing (Units: mm/[inch], Tolerance: ± 0.5 mm)

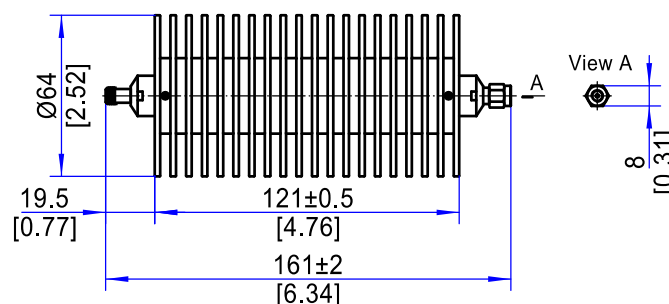

**Ordering Information:**Model: **YSFA100-XX-YY-S**

XX = Frequency Range (4 GHz, 8 GHz, 12.4 GHz, 18 GHz )

YY = Attenuation Value in dB

Example: 8 GHz, 10 dB→**YSFA100-8-10-S**