

YSDC20-18-40-20-K

Directional Coupler, 20 W, 18-40 GHz, 20 dB coupling, 2.92 mm

Key Features

- 18-40 GHz ultra-wideband
- 20 dB nominal coupling (± 1 dB)
- Low insertion loss (≤ 1.5 dB typ.)
- Compact 2.92 mm female interface
- 20 W CW power handling

Applications

- Broadband test & measurement
- Signal monitoring & sampling
- Radar & communication systems
- Power measurement setups
- High-frequency module integration

Electrical Specifications		
1	Frequency Range	18-40 GHz
2	Coupling	20 \pm 1 dB
3	Coupling Flatness	$\leq \pm 0.7$ dB
4	Main Line VSWR	$\leq 1.5@18-26.5\text{GHz}$ / $\leq 1.6@26.5-40\text{GHz}$
5	Secondary Line VSWR	$\leq 1.5@18-26.5\text{GHz}$ / $\leq 1.6@26.5-40\text{GHz}$
6	Insertion Loss	$\leq 1\text{dB}@18-26.5\text{GHz}$ / $\leq 1.5\text{dB}@26.5-40\text{GHz}$
7	Directivity	≥ 12 dB
8	Power	20 W(CW)
Environmental Specifications		
1	Operating Temperature	-55°C to +85°C
Mechanical Specifications		
1	Connectors	2.92 mm Female
2	Surface Finishing	Natural Conductive Oxidation
3	Dimensions ¹	40×16×12.7 mm / [1.57×0.63×0.50 in]

Outline Drawing (Units: mm/[inch], Tolerance: ± 0.3 mm)

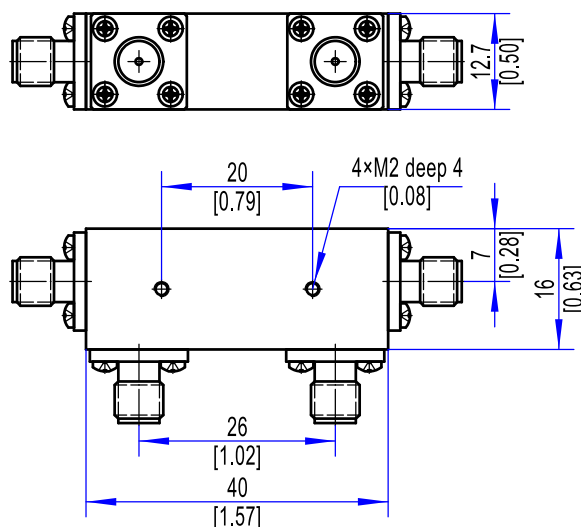

Note 1: Excluding Connector size