

# YSDC100-R8-12R75-10-N

Directional Coupler, 100 W, 0.8-12.75 GHz, 10 dB coupling, N-Type

## Key Features

- 0.5 – 12.75 GHz ultra-wideband
- 10 dB nominal coupling ( $\pm 0.5$  dB)
- Low insertion loss ( $\leq 1.5$  dB typ.)
- Compact SMA female interface
- 100 W CW power handling

## Applications

- Broadband test & measurement
- Signal monitoring & sampling
- Radar & communication systems
- Power measurement setups
- High-frequency module integration

Electrical Specifications		
1	Frequency Range	0.8-12.75 GHz
2	Coupling	10 $\pm 0.5$ dB
3	Coupling Flatness	$\leq \pm 1$ dB
4	VSWR	$\leq 1.4:1$
5	Insertion Loss	$\leq 1.5$ dB
6	Directivity	$\geq 15$ dB
7	Power	100 W(CW)
Environmental Specifications		
1	Operating Temperature	-55°C to +85°C
Mechanical Specifications		
1	Connectors	SMA Female
2	Dimensions <sup>1</sup>	88.9×17.8×12.7 mm / [3.5×0.7×0.5 in]

## Outline Drawing (Units: mm/[inch], Tolerance: $\pm 0.3$ mm)

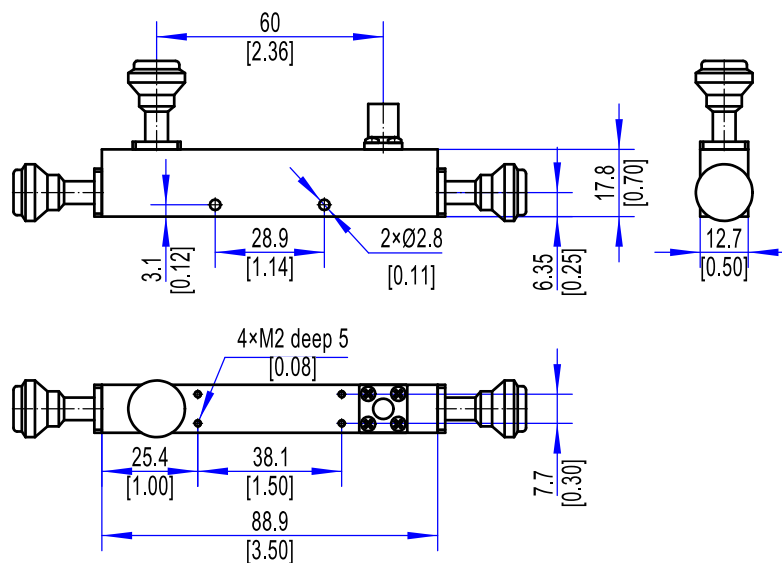

Note 1: Excluding Connector size