

# YS8WPD80-R1-1-S

8-Way Wilkinson Power Divider, 80 W, 0.1-1 GHz, SMA

## Key Features

- 0.1-1 GHz Wideband Coverage
- Low Insertion Loss
- Excellent Amplitude & Phase Balance
- High Isolation ( $\geq 15$  dB)
- 80 W Power Handling

## Applications

- RF & Microwave Systems
- Test & Measurement
- Radar & EW Systems
- Communication Networks
- Signal Distribution

Electrical Specifications		
1	Frequency Range	0.1-1 GHz
2	Insertion Loss	$\leq 1.3$ dB
3	Input Port VSWR	$\leq 1.35:1$
4	Output Port VSWR	$\leq 1.5:1$
5	Isolation	$\geq 15$ dB
6	Amplitude Balance	$\leq \pm 0.2$ dB
7	Phase Balance	$\leq \pm 5^\circ$
8	Power Handling	80 W(CW)
9	Impedance	50 $\Omega$
Environmental Specifications		
1	Operating Temperature	-55°C to +85°C
Mechanical Specifications		
1	Connectors	SMA Female
2	Surface Finishing	Natural Conductive Oxidation
3	Dimensions <sup>1</sup>	164×126×26 mm / [6.46×4.96×1.02 in]

**Outline Drawing** (Units: mm/[inch], Tolerance:  $\pm 0.3$  mm)

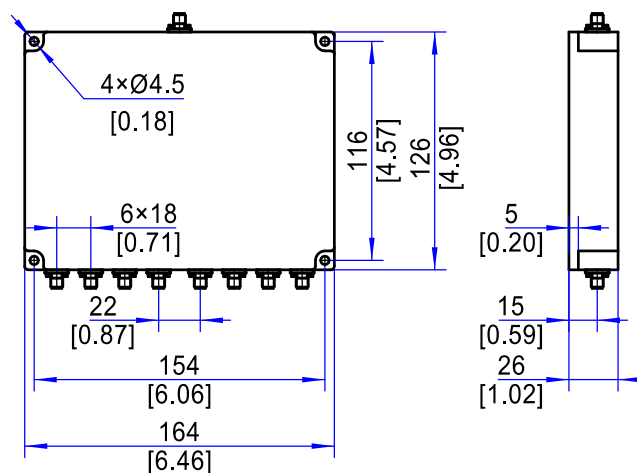

Note 1: Excluding Connectors