

YS8WPD300-R87-1-N

8-Way Wilkinson Power Divider, 300 W, 0.87-1.005 GHz, N-Type

Key Features

- 0.87-1.005 GHz Wideband Coverage
- Low Insertion Loss
- Excellent Amplitude & Phase Balance
- High Isolation (≥ 18 dB)
- 300 W Power Handling

Applications

- RF & Microwave Systems
- Test & Measurement
- Radar & EW Systems
- Communication Networks
- Signal Distribution

Electrical Specifications		
1	Frequency Range	0.87-1.005 GHz
2	Insertion Loss	≤ 0.6 dB
3	Input Port VSWR	$\leq 1.3:1$
4	Isolation	≥ 18 dB
5	Amplitude Balance	$\leq \pm 0.2$ dB
6	Phase Balance	$\leq \pm 3^\circ$
7	Power Handling	300 W(CW); 10 KW(PK)
8	Impedance	50 Ω
Environmental Specifications		
1	Operating Temperature	-10°C to +50°C
2	Storage Temperature	-40°C to +70°C
Mechanical Specifications		
1	Connectors	N-Type Female
2	Surface Finishing	Natural Conductive Oxidation
3	Dimensions ¹	360×252×22 mm / [14.17×9.92×0.87 in]

Outline Drawing (Units: mm/[inch], Tolerance: ± 0.3 mm)

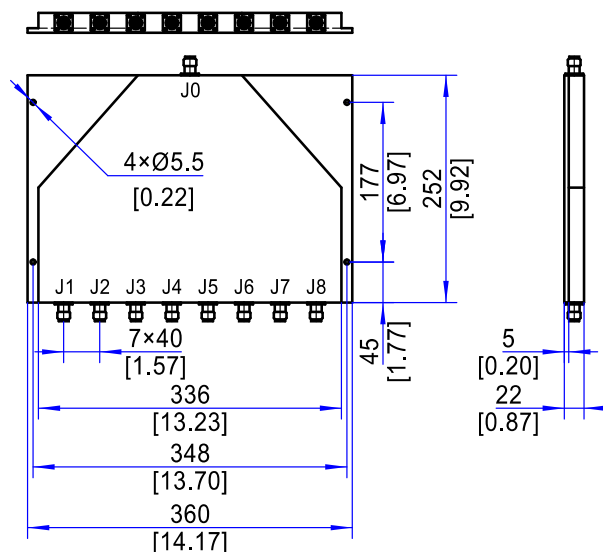

Note 1: Excluding Connectors