

YS8WPD250-R1-R4-S

8-Way Wilkinson Power Divider, 250 W, 0.1-0.4 GHz, SMA

Key Features

- 0.1-0.4 GHz Wideband Coverage
- Low Insertion Loss
- Excellent Amplitude & Phase Balance
- High Isolation (≥ 18 dB)
- 250 W Power Handling

Applications

- RF & Microwave Systems
- Test & Measurement
- Radar & EW Systems
- Communication Networks
- Signal Distribution

Electrical Specifications		
1	Frequency Range	0.1-0.4 GHz
2	Insertion Loss	≤ 1.1 dB
3	Input Port VSWR	$\leq 1.3:1$
4	Output Port VSWR	$\leq 1.45:1$
5	Isolation	≥ 18 dB
6	Amplitude Balance	$\leq \pm 0.2$ dB
7	Phase Balance	$\leq \pm 4^\circ$
8	Power Handling	250 W
9	Impedance	50 Ω
Environmental Specifications		
1	Operating Temperature	-55°C to +85°C
Mechanical Specifications		
1	Connectors	SMA Female
2	Surface Finishing	Natural Conductive Oxidation
3	Dimensions ¹	164×126×26 mm / [6.46×4.96×1.02 in]

Outline Drawing (Units: mm/[inch], Tolerance: ± 0.3 mm)

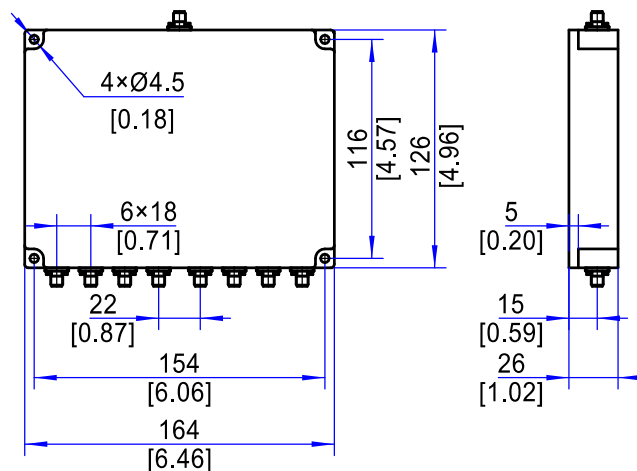

Note 1: Excluding Connectors