

# YS4WPD10-2-18-S

4-Way Wilkinson Power Divider, 10 W, 2-18 GHz, SMA

## Key Features

- 2-18 GHz Wideband Coverage
- Low Insertion Loss
- Excellent Amplitude & Phase Balance
- High Isolation ( $\geq 16$  dB)
- 10 W Power Handling

## Applications

- RF & Microwave Systems
- Test & Measurement
- Radar & EW Systems
- Communication Networks
- Signal Distribution

Electrical Specifications		
1	Frequency Range	2-18 GHz
2	Insertion Loss	$\leq 2.4$ dB
3	Input Port VSWR	$\leq 1.7:1$
4	Isolation	$\geq 16$ dB
5	Amplitude Balance	$\leq \pm 0.6$ dB
6	Phase Balance	$\leq \pm 8^\circ$
7	Power Handling	Forward Power: 10 W; Reverse Power: 1 W
8	Impedance	50 $\Omega$
Environmental Specifications		
1	Operating Temperature	-55°C to +85°C
Mechanical Specifications		
1	Connectors	SMA Female
2	Surface Finishing	Putty filling and gray-white paint spraying
3	Dimensions <sup>1</sup>	69×60×10 mm / [2.72×2.36×0.39 in]

## Outline Drawing (Units: mm/[inch], Tolerance: $\pm 0.3$ mm)

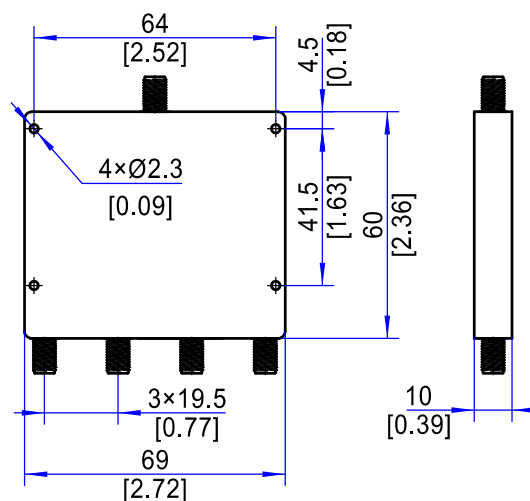

Note 1: Excluding Connectors