

YS2WPD30-30M-R8-S

2-Way Wilkinson Power Divider, 30 W, 0.03-0.8 GHz, SMA

Key Features

- 0.03-0.8 GHz Wideband Coverage
- Low Insertion Loss
- Excellent Amplitude & Phase Balance
- High Isolation (≥ 18 dB)
- 30 W Power Handling

Applications

- RF & Microwave Systems
- Test & Measurement
- Radar & EW Systems
- Communication Networks
- Signal Distribution

| Electrical Specifications | | |
|------------------------------|-------------------------|-----------------------------------|
| 1 | Frequency Range | 0.03-0.8 GHz |
| 2 | Insertion Loss | ≤ 0.5 dB |
| 3 | Input Port VSWR | $\leq 1.3:1$ |
| 4 | Output Port VSWR | $\leq 1.5:1$ |
| 5 | Isolation | ≥ 18 dB |
| 6 | Amplitude Balance | $\leq \pm 0.2$ dB |
| 7 | Phase Balance | $\leq \pm 4^\circ$ |
| 8 | Power Handling | 30 W |
| 9 | Impedance | 50 Ω |
| Environmental Specifications | | |
| 1 | Operating Temperature | -55°C to +85°C |
| Mechanical Specifications | | |
| 1 | Connectors | SMA Female |
| 2 | Surface Finishing | Natural Conductive Oxidation |
| 3 | Dimensions ¹ | 42×56×18 mm / [1.65×2.20×0.71 in] |

Outline Drawing (Units: mm/[inch], Tolerance: ± 0.3 mm)

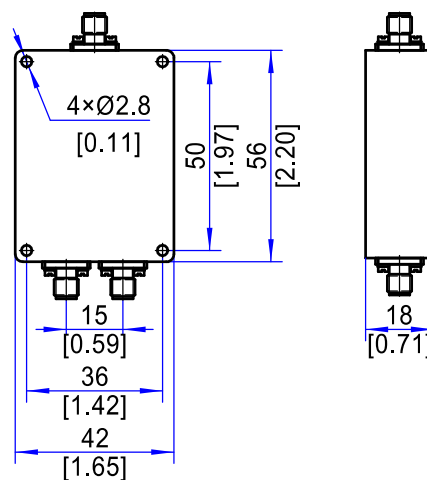

Note 1: Excluding Connectors