

## YS2RPD2-DC-6-S-1

2-Way Resistive Resistive Power Divider, 2 W, DC-6 GHz, SMA

### Key Features

- DC-6 GHz Broadband Coverage
- Stable Resistive Design
- Good Port Matching (VSWR  $\leq 1.35$ )
- Compact & Lightweight Structure
- Reliable 2 W Power Handling

### Applications

- Test & Measurement Systems
- Broadband Signal Distribution
- Lab & R&D Setups
- Communication Systems
- General RF Integration

Electrical Specifications		
1	Frequency Range	DC-6 GHz
2	Insertion Loss	$\leq 4.2$ dB(Excluding theoretical loss 3.01 dB)
3	Input Port VSWR	$\leq 1.25:1$
4	Output Port VSWR	$\leq 1.35:1$
5	Amplitude Balance	$\leq \pm 0.3$ dB
6	Phase Balance	$\leq \pm 3^\circ$
7	Power Handling	Forward Power: 2 W
8	Impedance	50 $\Omega$
Environmental Specifications		
1	Operating Temperature	-35°C to +75°C
Mechanical Specifications		
1	Connectors	SMA Female
2	Surface Finishing	Natural Conductive Oxidation
3	Dimensions <sup>1</sup>	28×28×10 mm / [1.1×1.1×0.39 in]

### Outline Drawing (Units: mm/[inch], Tolerance: $\pm 0.3$ mm)

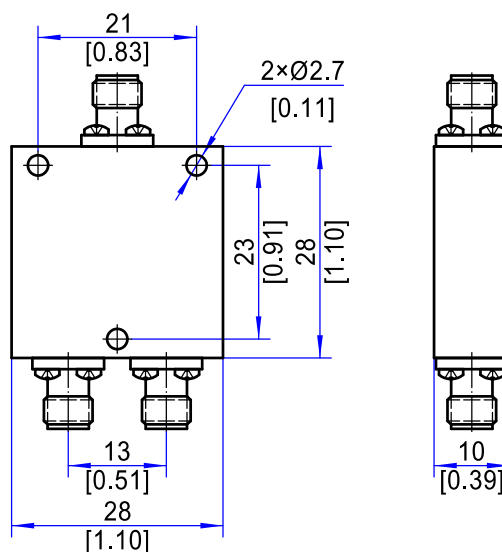

Note 1: Excluding Connectors